



Collaboration on Floor Plans



Summer Camp City & Design Sharing



For additional information on ACE go to [acementor.org](http://acementor.org). ACE is looking to expand into Kuna, West Treasure Valley and Idaho Panhandle! To register for the 2025 sessions go to [acementor.org](http://acementor.org) student drop down, registration or scan the below QR code. You can also email us at [Idaho@acementor.org](mailto:Idaho@acementor.org)



Follow us on social media:

[facebook - ACEmentorIdaho](https://www.facebook.com/ACEmentorIdaho)

[linkedin at ace-mentor-idaho](https://www.linkedin.com/company/ace-mentor-idaho)

[instagram.com/acementoridaho/](https://www.instagram.com/acementoridaho/)



**ACE Mentor Program  
Idaho invites you to  
join our Program**

**For 2025**

**Learn about**

**Architecture**

**Construction**

**Engineering**

**From Professionals**

**Starting week of January 13, 2025  
Sessions will be held in Downtown Boise,  
Meridian and Kuna**

**MORE DETAILS INSIDE**



Trades Day making tables



2023 Scholarship Winners



2023 Summer Camp Winners

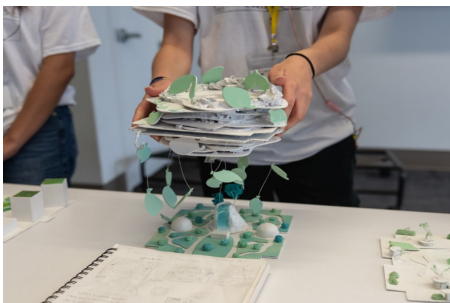

Summer camp vertical city

## WHAT IS ACE?

Is part of a national, FREE award winning, after school program designed to attract high school students who have the curiosity and drive to learn about various career paths in the design and construction industry!

As a student, you'll join a team of other students along with professional mentors who will lead you through various sessions exploring different facets of a hypothetical project. ACE immerses you into how ACE professions interact with one another in life-like design and building projects!

## OFTEN WONDER:

Why are Buildings Built?  
How Does Planning and Design Work Begin?  
How Do Buildings Stand Up?  
How are they built to be habitable environments?  
Who Approves the Design and Plans?  
How Does it Get Built?  
How is a Contractor Selected?  
What is a Construction Schedule and  
Why is IT Important?

## OPPORTUNITIES

For scholarships, a trip to summer camp at University of Colorado School of Architecture, paid externships, meet and work with professionals within the industry, and tour offices.

## TYPICAL ACE CURRICULUM

The ACE hypothetical Project will explore these different facets of the architectural, construction and engineering professions

- Introduction
- Site Visit along with site analysis
- Programming along with bubble diagrams
- Floor Plans
- Environmental Sustainability
- Project Construction Management - Costs, Schedule
- Construction site visit
- Landscaping Plans
- Structural Systems
- Materials and Exterior façade design
- Mechanical, Electrical and Plumbing system designs
- Civil Engineering, Surveying
- Local College/University Tour such as Boise State and U of I Boise
- Cost Estimating
- Pre-presentation collaboration session
- Trades Day session
- Final Presentation of the hypothetical Project
- Two hour sessions after school, once a week for 14 weeks